

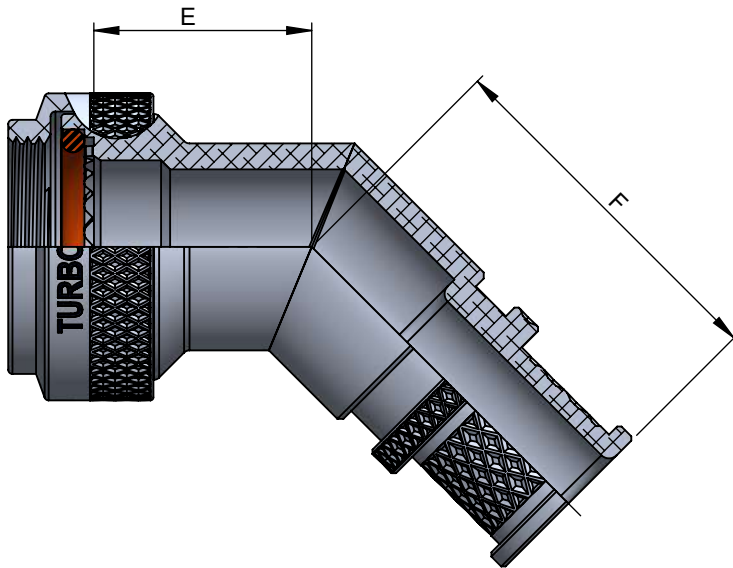

S = STRAIGHT



F = 45 DEGREE

BANDING OPTIONS



S = CONSTANT FORCE SPRING



T = TERMINATION BAND

FOR SELECTING SUITABLE TERMINATION ACCESSORY, GO TO ACCESSORIES SECTION IN CATALOG

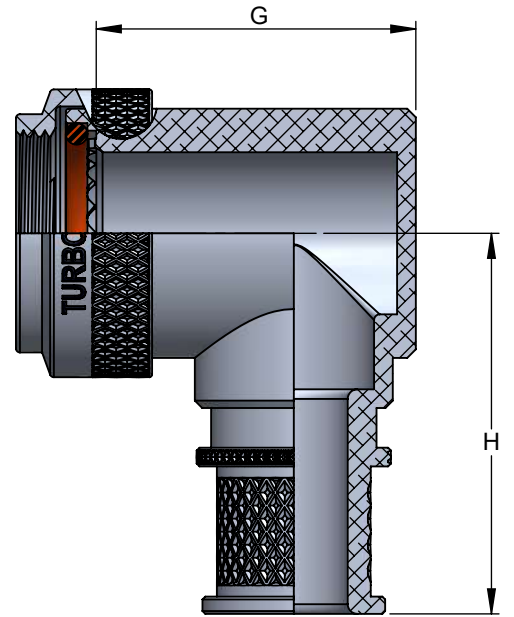

N = 90 DEGREE

TB 21 - A 3 N VB - 18 07 - ST - T

<p>BRAND IDENTIFIER</p> <p>PRODUCT SERIES CODE</p> <p>CONNECTOR INTERFACE (SEE PAGE - 07)</p> <p>COUPLING RING OPTION (SEE PAGE - 05)</p> <p>ANGLE S = STRAIGHT F = 45° N = 90°</p>	<p>BANDING OPTION S = CF SPRING T = TERMINATION BAND (OMIT FOR NONE)</p> <p>LENGTH CODE ONLY FOR STRAIGHT PARTS. ST FOR STANDARD LENGTH (L) - 1.35" (1/2" INCREMENT. FOR EXAMPLE 8 = 4 INCHES)</p> <p>CABLE ENTRY (SEE TABLE - II)</p> <p>SHELL SIZE (SEE TABLE - I)</p> <p>MATERIAL & FINISH (SEE PAGE - 06)</p>
--	--

		DATE
DRAWN :	AD	29-10-2020
CHECKED :	AD	29-10-2020
APPROVED :	MR	29-10-2020



TURBO INDIA

INTERCONNECT SOLUTIONS

#114, 1st Floor, P C Industrial Estate, Kamakshipalya,
Magadi Rd, Bangalore 560 079, Karnataka, India

THIS DRAWING IS COPYRIGHT AND THE PROPERTY OF TURBO INDIA INTERCONNECT SOLUTIONS. IT MUST NOT BE COPIED, USED FOR MANUFACTURE OR OTHERWISE DISCLOSED WITHOUT PRIOR WRITTEN CONSENT OF THE COMPANY.

UNLESS OTHERWISE SPECIFIED : ALL DIMENSIONS IN MILLIMETRES
GENERAL TOL:
LINEAR : ± 0.10MM
ANGULAR : ± 2°

MATERIAL :	---	REV.No 01
WEIGHT :	---	
ASSEMBLY USED ON: ---		

DESCRIPTION : EMI/RFI BAND OR SPRING ADAPTER	
PART NUMBER / SERIES: SERIES 21	PAGE:NO 16

TABLE - I SHELL SIZE							
CONNECTOR DESIGNATOR			RING DIMENSION	ELBOW DIMENSIONS			
A&B	F&D	H	Ø C MAX	E MAX	F MAX	G MAX	H MAX
08	08	09	15.67	25.70	29.50	34.93	35.99
10	10	11	18.64	26.20	30.20	36.50	37.59
12	12	13	21.79	26.90	30.70	39.67	39.45
14	14	15	24.99	27.40	31.50	42.85	41.00
16	16	17	28.24	28.20	32.00	44.45	42.62
18	18	19	30.93	28.40	32.30	47.63	45.03
20	20	21	34.16	29.20	33.00	49.23	45.62
22	22	23	37.28	29.70	33.80	52.37	47.22
24	24	25	40.46	30.50	34.30	53.37	48.74
28			50.01	27.90	35.10	53.20	48.70
61*			41.98	-	-	-	-

SIZE 61* AVAILABLE ON STRAIGHT ONLY

1. WHEN MAXIMUM CABLE ENTRY IS EXCEEDED , STYLE-2 WILL BE SUPPLIED . IN THAT CONDITION, DIMENSIONS E,F,G AND H WILL NOT APPLY.
2. FOR ANY KIND OF CUSTOMISATION ON THIS BACKSHELL, REACHOUT TO US ON sales@turboindia.co.in

TABLE-II CABLE ENTRY		
DASH NO	Ø K +0.10	Ø M +0.10
02	3.20	7.90
03	4.80	9.50
04	6.40	11.10
05	7.90	12.70
06	9.50	14.30
07	11.10	15.80
08	12.70	17.40
09	14.30	19.10
10	15.90	20.60
11	17.50	22.20
12	19.10	23.80
13	20.60	25.40
14	22.20	27.00
15	23.80	28.50
16	25.40	30.10
17	27.00	31.80
18	28.60	33.30
20	31.80	36.50
22	34.90	39.70
24	38.10	42.80
26	41.30	46.00
27	44.50	49.20
28	47.60	52.40
29	50.80	55.50

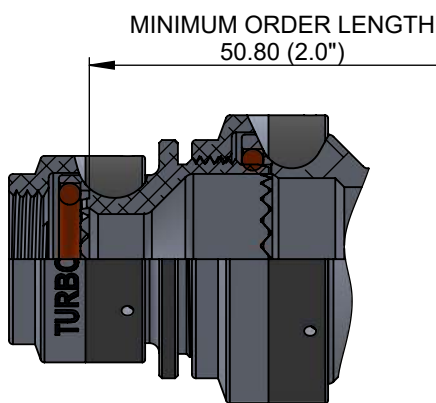

STYLE -2
STRAIGHT

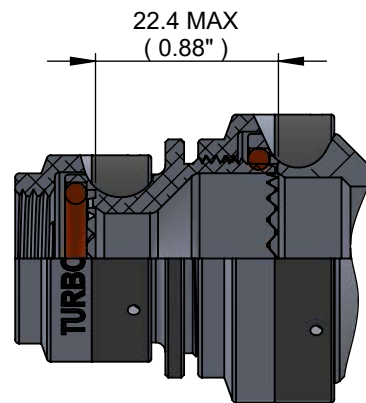

STYLE -2
45° & 90°

		DATE
DRAWN :	AD	01-10-2020
CHECKED :	AD	01-10-2020
APPROVED :	MR	01-10-2020



TURBO INDIA
INTERCONNECT SOLUTIONS

#114, 1st Floor, P C Industrial Estate, Kamakshipalya,
Magadi Rd, Bangalore 560 079, Karnataka, India

THIS DRAWING IS COPYRIGHT AND THE PROPERTY OF TURBO INDIA INTERCONNECT SOLUTIONS. IT MUST NOT BE COPIED, USED FOR MANUFACTURE OR OTHERWISE DISCLOSED WITHOUT PRIOR WRITTEN CONSENT OF THE COMPANY.

UNLESS OTHERWISE SPECIFIED :
ALL DIMENSIONS IN MILLIMETRES
GENERAL TOL:
LINEAR : ± 0.10MM
ANGULAR : ± 2°

MATERIAL :	---	REV.No 01
WEIGHT :	---	
ASSEMBLY USED ON:		

DESCRIPTION :	
EMI/RFI BANDING OR SPRING ADAPTER	
PART NUMBER / SERIES:	PAGE:NO
SERIES 21	17